

Accessory Catalogue 2021

MF1 – Wall Fix Hinge



Details

- Hinges open in and out. Self closing from approximately 30°.
- Centre T mount plate with 4 wall fixing holes.
- Suitable for 10mm glass (adaptable to other thicknesses).
- 35kg per two hinges & 52.5kg per three hinges with 800mm maximum door width.

Available Finishes

Polished Chrome, Brushed Satin Chrome, Polished Gold, Matte Black and more

Additional Information

Supplied with Hex & Slotted Head machine screws & 50mm wall fix screws

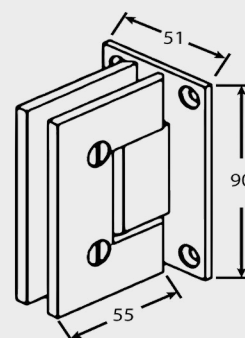

MF1-L3 – Elite Wall Offset Hinge



Details

- Hinges open in & out. Self closing from approximately 30°.
- Single side mount plate with 3 wall fixing holes.
- Suitable for 10mm glass (adaptable to other thicknesses).
- 35kg per two hinges & 52.5kg per three hinges with 800mm maximum door width.

Available Finishes

Polished Chrome, Brushed Satin Chrome, Polished Gold, Matte Black and more

Additional Information

Supplied with Hex & Slotted Head machine screws & 50mm wall fix screws.

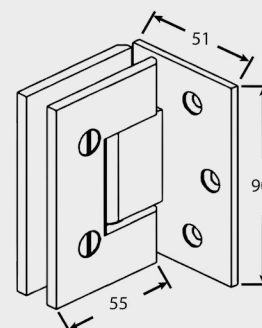

Dimensions

Base Material: Brass

MF2 – Elite Hinge 180°



Details

- Hinges open in & out at an 180° angle. Self closing from approximately 30°.
- Suitable for 10mm glass (adaptable to other thicknesses).
- 35kg per two hinges & 52.5kg per three hinges with 800mm maximum door width.

Available Finishes

Polished Chrome, Brushed Satin Chrome, Polished Gold, Matte Black and more

Additional Information

Supplied with Hex & Slotted Head machine screws

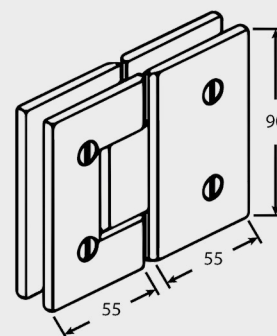

Dimensions

Base Material: Brass

MF2-135 – Elite Hinge 135°



Details

- Hinges open in & out at an 135° angle. Self closing from approximately 30°.
- Suitable for 10mm glass (adaptable to other thicknesses).
- 35kg per two hinges & 52.5kg per three hinges with 800mm maximum door width.

Available Finishes

Polished Chrome, Brushed Satin Chrome, Polished Gold, Matte Black and more

Additional Information

Supplied with Hex & Slotted Head machine screws

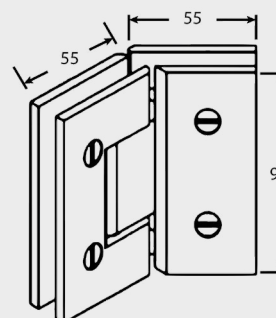

Dimensions

Base Material: Brass

Accessory Catalogue 2021

MF2-90 – Elite Hinge 90 Glass to Glass°



Details

- Hinges open in & out at 90°. Self closing from approximately 30°
- Suitable for 10mm glass (adaptable to other thicknesses)
- 35kg per two hinges & 52.5kg per three hinges with 800mm maximum door width

Available Finishes

Polished Chrome, Brushed Satin Chrome, Polished Gold, Matte Black and more

Additional Information

- Supplied with Hex & Slotted Head machine screws

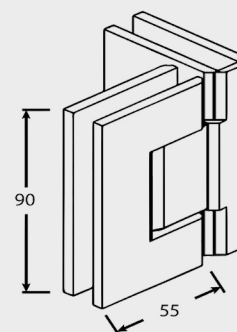

MBS6/8/10/12 – Wall/Shelf Brackets



Details

- Half Square Shelf Bracket
- Suitable for 6/8/10/12mm glass
- One fixing hole

Available Finishes

Polished Chrome, Brushed Satin Chrome, Polished Gold, Matte Black and more

Additional Information

2-3mm clearance between glass & surface

Dimensions

Base Material: Brass

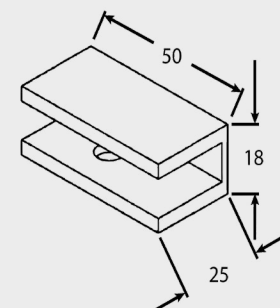

MBS10VL – Wall Brackets Vertical Leg



Details

- 180° Square Glass to NIB Wall/Bath Bracket
- Suitable for 10mm Glass
- No hole required in glass

Available Finishes

Polished Chrome, Brushed Satin Chrome, Polished Gold, Matte Black and more

Additional Information

2-3mm clearance between glass & surface

Dimensions

Base Material: Brass

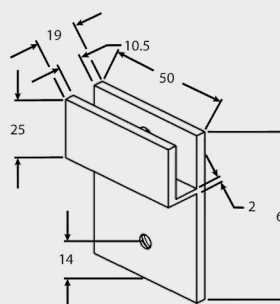

MBS10HL – Wall Brackets Horizontal Leg



Details

- 90° Square Glass to NIB Wall/Bath Bracket
- Suitable for 6/8/10/12mm glass
- One fixing hole

Available Finishes

Polished Chrome, Brushed Satin Chrome, Polished Gold, Matte Black and more

Additional Information

2-3mm clearance between glass & surface

Dimensions

Base Material: Brass

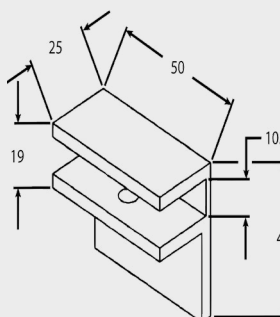

Dimensions

Base Material: Brass

Accessory Catalogue 2021

MK20 – Knob Standard 20mm

Details

- Groove Pull Knob Set
- To suit 10mm glass



Available Finishes

Polished Chrome, Brushed Satin Chrome, Polished Gold, Matte Black and more

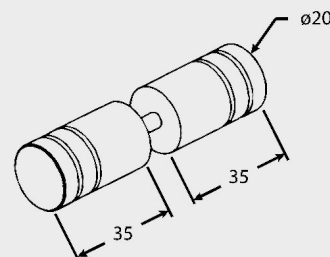

MK25 – Knob Standard 25mm

Details

- Big Groove Pull Knob Set
- To suit 10mm glass



Available Finishes

Polished Chrome, Brushed Satin Chrome, Polished Gold, Matte Black and more

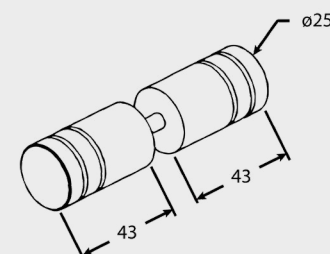

MKS25 – Square Knob

Details

- Square Pull Knob Set
- To suit 10mm glass



Available Finishes

Polished Chrome, Brushed Satin Chrome, Polished Gold, Matte Black and more

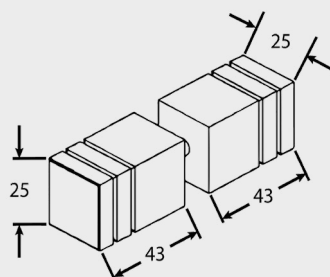

MK403 – Ridged Knob

Details

- Ridges Pull Knob Set
- To suit 10mm glass



Available Finishes

Polished Chrome, Brushed Satin Chrome, Polished Gold, Matte Black and more

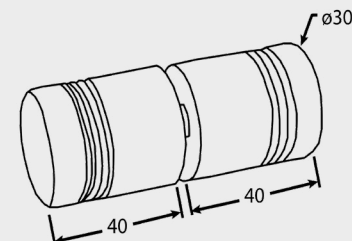

Accessory Catalogue 2021

SK30 – Deep Groove Knob



Details

- Deep Groove Pull Knob Set
- To suit 10mm glass

Available Finishes

Polished Chrome, Brushed Satin Chrome, Polished Gold, Matte Black and more

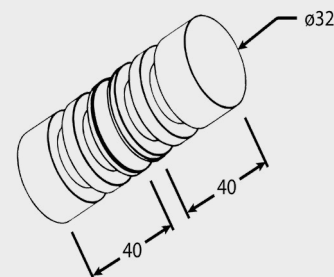

M250 – Double D Shower Handle 250



Details

- Double D Pull Handle Set
- To suit 10mm glass
- Round tube

Available Finishes

Polished Chrome and Brushed Satin Chrome

Additional Information

Base Material: 304 Stainless Steel

Dimensions

Base Material: Brass

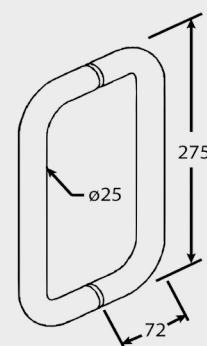

M500 – Double D Shower Handle 500



Details

- Double D Pull Handle Set
- To suit 10mm glass
- Round tube

Available Finishes

Polished Chrome and Brushed Satin Chrome

Additional Information

Base Material: 304 Stainless Steel

Dimensions

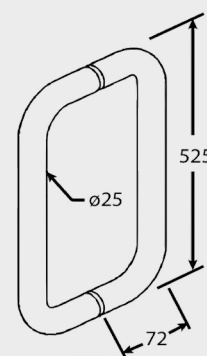

TRK250 – Tower Rail Handle with Knob 250



Details

- Towel Rail Handle with Knob
- To suit 10mm glass
- Round tube

Available Finishes

Polished Chrome and Brushed Satin Chrome

Additional Information

Base Material: 304 Stainless Steel

Dimensions

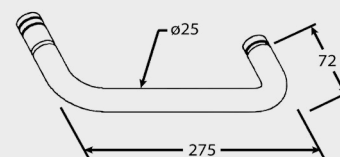

Dimensions

Accessory Catalogue 2021

TRK300 – Tower Rail Handle with Knob 300



Details

- Towel Rail Handle with Knob
- To suit 10mm glass
- Round tube

Available Finishes

Polished Chrome and Brushed Satin Chrome

Additional Information

Base Material: 304 Stainless Steel

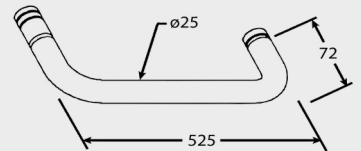

CS15 – Channel Section



Details

- 15mm x 18mm x 2500mm

Available Finishes

Polished Silver Anodised, Natural Anodised, Polished Gold Anodised and more

Additional Information

Base Material: Aluminium

Dimensions

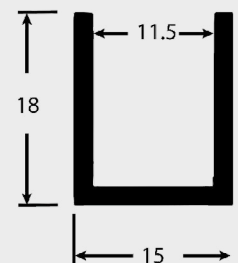

MWS3 – Square Waterbar

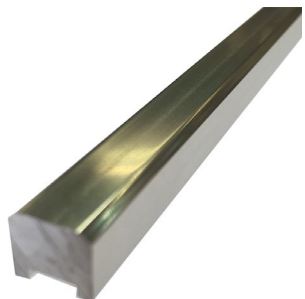

Details

- 10mm x 10mm x 3000mm

Available Finishes

Polished Silver Anodised, Natural Anodised, Polished Gold Anodised and more

Additional Information

Base Material: Aluminium

Dimensions

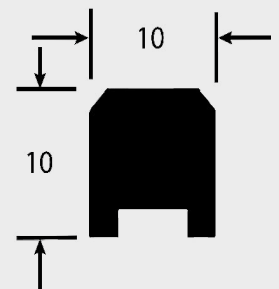

MSH15 – Shower Hob



Details

- 25mm x 15mm x 2100mm

Available Finishes

Polished Chrome, Brushed Satin Chrome, Polished Gold, Matte Black and more

Additional Information

Base Material: Aluminium

Dimensions

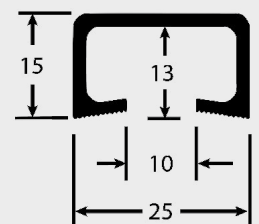

Dimensions

Accessory Catalogue 2021

MWS10-6 – Clear Waterseal



Details

- Rigid channel & flexible fin
- 2200mm
- Suitable for 10mm glass

Available Finishes

Translucent

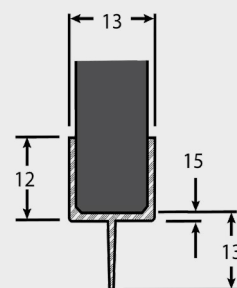

MWS6-10 – Clear Waterseal 6mm Length



Details

- Rigid channel/water deflector & dual flexible fins
- 2200mm
- Suitable for 6/8/10mm glass

Available Finishes

Translucent

Dimensions

Base Material: PVC

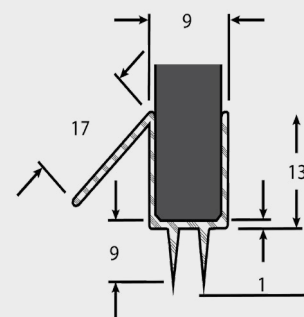

MWS10-10 – Clear Waterseal 10mm Length



Details

- Rigid channel/water deflector & dual flexible fins
- 2200mm
- Suitable for 6/8/10mm glass

Available Finishes

Translucent

Dimensions

Base Material: PVC

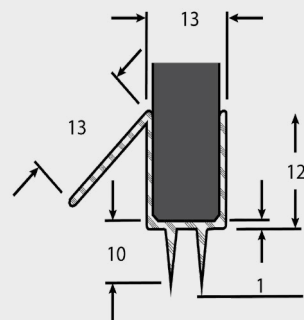

MWS10-13 – Bubble Waterseal



Details

- Rigid channel & bubble seal
- 2200mm
- Suitable for 10mm glass

Available Finishes

Translucent

Dimensions

Base Material: PVC

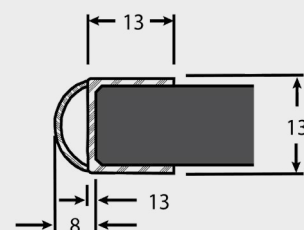

Dimensions

Base Material: PVC

Accessory Catalogue 2021

GS150 – Glass Shelf 150mm



Details

- 150mm Radius Glass Corner Shelf
- 10mm toughened glass
- Flat polished edges
- 30 x 30 cutout from corner

Available Finishes

Clear

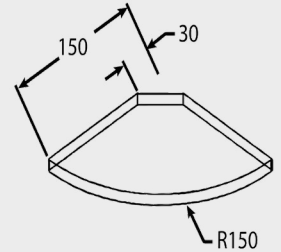

GS200 – Glass Shelf 200mm



Details

- 200mm Radius Glass Corner Shelf
- 10mm toughened glass
- Flat polished edges
- 30 x 30 cutout from corner

Available Finishes

Clear and Ultra Clear

Dimensions

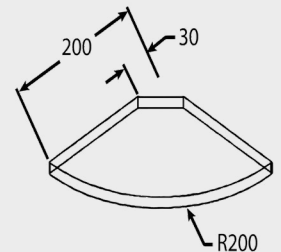

GS300 – Glass Shelf 300mm



Details

- 300mm Radius Glass Corner Shelf
- 10mm toughened glass
- Flat polished edges
- 30 x 30 cutout from corner

Available Finishes

Clear

Dimensions

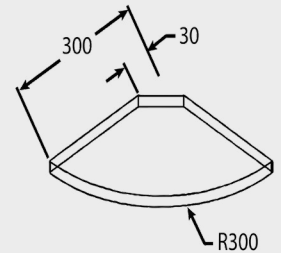

Dimensions